

BT30 VX - Mini Chuck

Features

- 3 μm - 0.0001" Runout @ 4X Diameter
- Front Locking System
- Coolant Thru
- Dynamically Pre-Balanced G2.5 @ 25,000 RPM or < 1gmm
- Tapers are ground better than AT3 for optimal T.I.R.

Optional (Order Separately):

- Wrench
- Torque Wrench
- Collets
- DIN-B Flange Coolant
- Fine Trim Balance
(Sample cutter required for balance compensation)

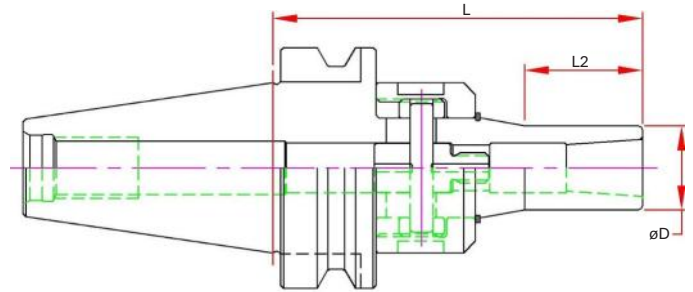

Dual Contact Spindle Part Number	Collet Range	D	L1 Projection	L2	Collet	Wrench	Locking Torque Max.
BT30-VX06-090-B	0.079 - 0.250	0.50	3.54	1.37	MX06	45-48 PIN	30 ft/lbs
BT30-VX08-092-B	0.125 - 0.394	0.787	3.62	1.21	MX08		

BT30 MX - Mini Chuck

Features

- 3 μm - 0.0001" Runout @ 4X Diameter
- Rear Draw Bolt Locking System
- Coolant Thru
- Dynamically Pre-Balanced G2.5 @ 25,000 RPM or < 1gmm
- Tapers are ground better than AT3 for optimal T.I.R.

Optional (Order Separately):

- Wrench
- Torque Wrench
- Collets, STD and Jet-Blast
- DIN-B Flange Coolant
- Fine Trim Balance
(Sample cutter required for balance compensation)

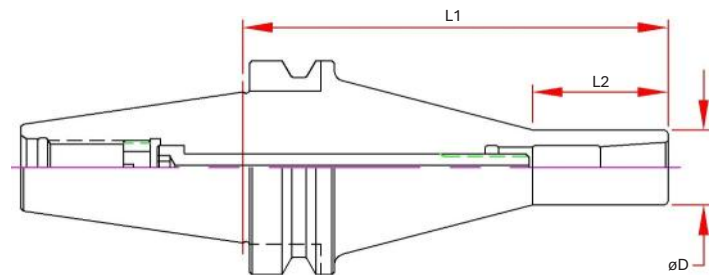

Dual Contact Spindle Part Number	Standard Spindle Part Number	Collet Range	D	L1 Projection	L2	Collet	Wrench	Locking Torque Max.
BT30-MX06-090-B	BT30-MX06-090	0.079 - 0.250	0.500	3.54	1.42	MX06	MXW05	20 ft/lbs
BT30-MX08-090-B	BT30-MX08-090	0.125 - 0.394	0.787	3.54	1.42	MX08		
BT30-MX12-105-B	BT30-MX12-105	0.157 - 0.500	1.000	4.13	1.38	MX12		