

# BT40 Shrink Fit - Metric

## Features

- 3  $\mu\text{m}$  - 0.0001" Runout Taper to Bore
- Manufactured from ISO-40CrMoV5 (H13) Material, Heat Treated for Optimum Elasticity and Tool Life
- Coolant Thru the Center
- Tapers are ground better than AT3 for optimal T.I.R.
- Dynamically Balanced for G2.5 @ 25,000 RPM or < 1 gmm
- Preset Screw included for 1/4" & larger for positive stop
- Designed for Carbide Cutting Tools with h6 shank tolerance

## Optional (Order Separately):

- Jet-Blast Coolant Ports - Add "J"
- DIN-B Coolant - Add "D"
- Fine Trim Balance (Sample cutter required for balance compensation)

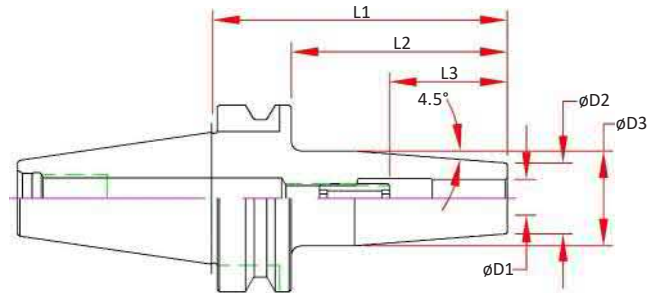

Part Number	D1 Bore	D2	D3	L1 Projection	L2	L3 Max Tool Enters	Preset Screw
BT40-SDM03-090	3.000	0.39	0.75	3.54	2.28	4.57	-
BT40-SDM03-160	3.000	0.39	0.75	6.30	5.43	7.73	-
BT40-SDM04-090	4.000	0.39	0.75	3.54	2.28	4.57	-
BT40-SDM04-160	4.000	0.39	0.75	6.30	5.43	7.73	-
BT40-SDM06-090	6.000	0.83	1.06	3.54	2.28	1.54	SCW-ASC-05-23
BT40-SDM06-160	6.000	0.83	1.06	6.30	5.43	1.54	SCW-ASC-05-23
BT40-SDM08-090	8.000	0.83	1.06	3.54	2.28	1.54	SCW-ASC-06-23
BT40-SDM08-160	8.000	0.83	1.06	6.30	5.43	1.54	SCW-ASC-06-23
BT40-SDM10-090	10.000	0.94	1.26	3.54	2.28	1.73	SCW-ASC-08-23
BT40-SDM10-160	10.000	0.94	1.26	6.30	5.43	1.73	SCW-ASC-08-23
BT40-SDM12-090	12.000	0.94	1.26	3.54	2.28	1.97	SCW-ASC-10-23
BT40-SDM12-160	12.000	0.94	1.26	6.30	5.43	1.97	SCW-ASC-10-23
BT40-SDM16-090	16.000	1.06	1.34	3.54	2.28	1.97	SCW-ASC-12-23
BT40-SDM16-160	16.000	1.06	1.34	6.30	5.43	1.97	SCW-ASC-12-23
BT40-SDM20-090	20.000	1.30	1.65	3.54	2.28	2.17	SCW-ASC-12-23
BT40-SDM20-160	20.000	1.30	1.65	6.30	5.43	2.17	SCW-ASC-12-23

CAT40

CAT50

BT30

BT 40

HSK 40E

HSK 63A

HSK 100A

STRAIGHT SHANKS

COLLETS

PARTS & ACCESS.

SHRINK MACHINES

INDEXERS

