

# BT40 Shrink Fit - Inch

## Features

- 3 μm - 0.0001" Runout Taper to Bore
- Manufactured from ISO-40CrMoV5 (H13) Material, Heat Treated for Optimum Elasticity and Tool Life
- X Jet-Blast Pluggable Coolant Ports
- Tapers are ground better than AT3 for optimal T.I.R.
- Dynamically Balanced for G2.5 @ 25,000 RPM or < 1 gmm
- Preset Screw included for 1/4" & larger for positive stop
- Designed for Carbide Cutting Tools with h6 shank tolerance

## Optional (Order Separately):

- Fine Trim Balance (Sample cutter required for balance compensation)

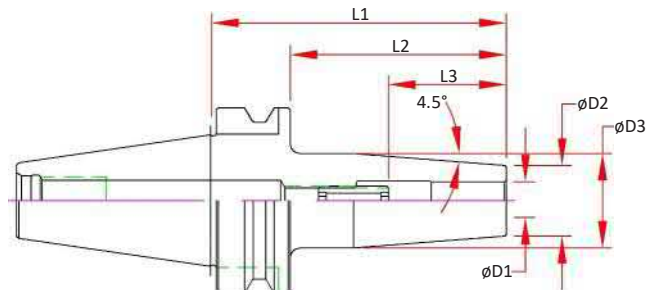

Dual Contact Spindle Part Number	D1 Bore	D2	D3	L1 Projection	L2	L3 Max Tool Enters	Preset Screw
BT40-SD012-090-B-X	0.1250	0.39	0.77	3.54	2.28	4.57	-
BT40-SD012-160-B-X	0.1250	0.39	0.77	6.30	5.43	7.73	-
BT40-SD018-090-B-X	0.1875	0.39	0.77	3.54	2.28	4.57	-
BT40-SD018-160-B-X	0.1875	0.39	0.77	6.30	5.43	7.73	-
BT40-SD025-090-B-X	0.2500	0.83	1.06	3.54	2.28	1.54	SCW-ASC-05-23
BT40-SD025-160-B-X	0.2500	0.83	1.06	6.30	5.43	1.54	SCW-ASC-05-23
BT40-SD031-090-B-X	0.3125	0.83	1.06	3.54	2.28	1.54	SCW-ASC-06-23
BT40-SD031-160-B-X	0.3125	0.83	1.06	6.30	5.43	1.54	SCW-ASC-06-23
BT40-SD037-090-B-X	0.3750	0.94	1.26	3.54	2.28	1.73	SCW-ASC-08-23
BT40-SD037-160-B-X	0.3750	0.94	1.26	6.30	5.43	1.73	SCW-ASC-08-23
BT40-SD050-090-B-X	0.5000	0.94	1.26	3.54	2.28	1.97	SCW-ASC-10-23
BT40-SD050-160-B-X	0.5000	0.94	1.26	6.30	5.43	1.97	SCW-ASC-10-23
BT40-SD062-090-B-X	0.6250	1.06	1.34	3.54	2.28	2.09	SCW-ASC-12-23
BT40-SD062-160-B-X	0.6250	1.06	1.34	6.30	5.43	2.09	SCW-ASC-12-23
BT40-SD075-090-B-X	0.7500	1.30	1.65	3.54	2.28	2.09	SCW-ASC-12-23
BT40-SD075-160-B-X	0.7500	1.30	1.65	6.30	5.43	2.09	SCW-ASC-12-23
BT40-SD100-100-B-X	1.0000	1.73	2.09	3.94	3.07	2.28	SCW-ASC-16-23
BT40-SD100-160-B-X	1.0000	1.73	2.09	6.30	5.43	2.28	SCW-ASC-16-23
BT40-SD125-100-B-X	1.2500	1.73	2.09	3.94	3.07	2.28	SCW-ASC-16-23
BT40-SD125-160-B-X	1.2500	1.73	2.09	6.30	5.43	2.28	SCW-ASC-16-23