

CAT50 Shell Mill Adapters

Features

- 3 μm - 0.0001" Bore Runout
- H5 Bore Tolerance or better
- Tapers are ground better than AT3 for optimal T.I.R.
- Coolant Thru Body
- Pre-Balanced for use @ 20,000 RPM

Optional (Order Separately):

- FX Coolant (add "F" to the part number)
- DIN-B Coolant (Select models)

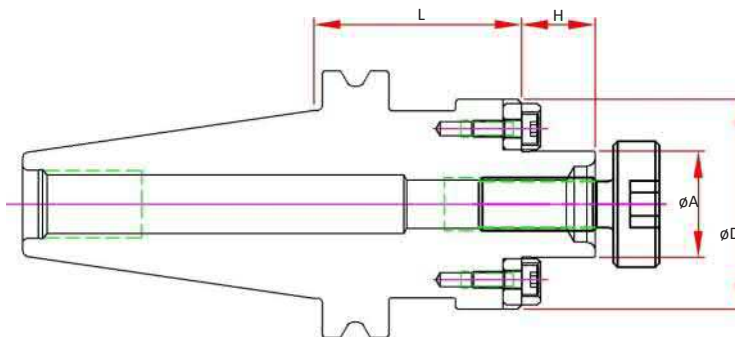

Dual Contact Spindle Part Number	Standard Spindle Part Number	A Pilot	D	H	L Projection	Drive Key Size	Drive Key Number	Mounting Screw Thread	Mounting Screw#
CAT50-SM075-0150-B	CAT50-SM075-0150				1.50				
CAT50-SM075-0350-B	CAT50-SM075-0350				3.50				
CAT50-SM075-0550-B	CAT50-SM075-0550				5.50				
CAT50-SM075-0800-B	CAT50-SM075-0800	0.75	1.75	0.69	8.00	0.312	DK-SM075	3/8-24	SCW-SM075
CAT50-SM075-1000-B-F**	CAT50-SM075-1000F**				10.00				
CAT50-SM075-1200-B-F**	CAT50-SM075-1200F**				12.00				
	CAT50-SM075-1500F**								
CAT50-SM100-0200-B	CAT50-SM100-0200				2.00				
CAT50-SM100-0400-B	CAT50-SM100-0400				4.00				
CAT50-SM100-0600-B	CAT50-SM100-0600	1.00	1.97	0.69	6.00	0.375	DK-SM100	1/2-20	SCW-SM100
CAT50-SM100-0800-B	CAT50-SM100-0800				8.00				
	CAT50-SM100-1200F**				12.00				
	CAT50-SM100-1500F**				15.00				
	CAT50-SM125-0150				1.50				
CAT50-SM125-0350-B	CAT50-SM125-0350				3.50				
CAT50-SM125-0550-B	CAT50-SM125-0550				5.50				
	CAT50-SM125-0800	1.25	2.75	0.69	8.00	0.500	DK-SM125	5/8-18	SCW-SM125
	CAT50-SM125-1000F**								
	CAT50-SM125-1200F**				12.00				
	CAT50-SM125-1500F**				15.00				
CAT50-SM150-0240-B	CAT50-SM150-0240				2.40		DK-SM150-C		
CAT50-SM150-0400-B	CAT50-SM150-0400	1.50	3.82	0.94	4.00	0.625	DK-SM150	3/4-16	SCW-SM150
CAT50-SM150-0600-B	CAT50-SM150-0600				6.00		DK-SM150		
CAT50-SM150-0800-B	CAT50-SM150-0800				8.00		DK-SM150		
CAT50-SM200-0400-B	CAT50-SM200-0400	2.00	4.37	0.94	4.00	0.750	DK-SM200	1"-14	SCW-SM200

** Stocked in "FX" Coolant Style Only