

CAT40 Bearing-less Mill Chucks



Features

- 5 µm - 0.0002" Runout @ 2 x Cutter Shank Dia.
- Works in both Standard and Dual Contact Spindles
- Designed for Tool Shanks w/ ISO h6 Class Tolerance
- Tapers are ground better than AT3 for optimal T.I.R.
- Sealed by Design for High Pressure Coolant
- Balanced for use @ 20,000 RPM

Optional (Order Separately):

- Torque Wrench
- Nylon Screw Seal for short tool shanks
- DIN-B Flange Coolant
- Jet-Blast Coolant Ports (for Solid Tooling)
- Fine Trim Balance
(Sample cutter required for balance compensation)
- For Non-Pull Out add -NP to the part number

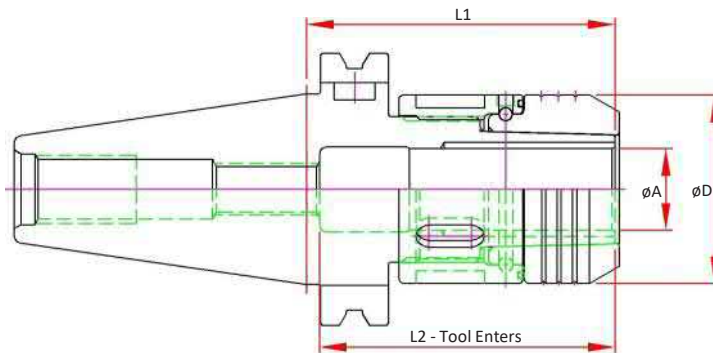

Note: BC Holders do "work in". Meaning the first couple of uses will require additional tightening torque.

Dual Contact Spindle Part Number	Standard Spindle Part Number	A Bore	D	L1 Projection	L2 Tool Enters	Coolant Seal Depth (Min. Shank Length)	Optional Preset Screw	Optional Torque Wrench Head	Grease & Torque
CAT40-BC037-0256-B		0.3750	1.38	2.56	2.36	1.38	ASC-12-30	TWSQ050-S38	100 ft/lbs
CAT40-BC050-0256-B	CAT40-BC050-0256	0.5000	1.38	2.56	2.36	1.38	ASC-12-30	TWSQ050-S38	100 ft/lbs
	CAT40-BC050-0400	0.5000	1.38	4.00	2.36	1.38	ASC-12-30	TWSQ050-S38	100 ft/lbs
CAT40-BC062-0256-B	CAT40-BC062-0256	0.6250	1.50	2.56	2.36	1.38	ASC-12-30	TWSQ050-S38	120 ft/lbs
CAT40-BC075-0283-B	CAT40-BC075-0283	0.7500	1.73	2.83	2.72	1.62	ASC-12-30	TWSQ050-S45	120 ft/lbs
CAT40-BC100-0300-B	CAT40-BC100-0300	1.0000	2.12	3.00	3.00	1.65	ASC-12-30	TWSQ050-S55	140 ft/lbs
CAT40-BC125-0350-B*	CAT40-BC125-0350*	1.2500	2.56	3.50	3.00	2.05	ASC-12-30	TWSQ050-S65	140 ft/lbs
CAT40-BCM12-0256-B		12mm	1.38	2.56	2.36	1.38	ASC-12-30	TWSQ050-S38	100 ft/lbs
CAT40-BCM16-0256-B		16mm	1.50	2.56	2.36	1.38	ASC-12-30	TWSQ050-S38	120 ft/lbs
CAT40-BCM20-0283-B		20mm	1.73	2.83	2.72	1.62	ASC-12-30	TWSQ050-S45	120 ft/lbs

* No ANSI Safety Area - will not function in umbrella style tool changers