

CAT40 MX - Mini Chuck



Features

- 3 μm - 0.0001" Runout @ 4X Diameter
- Rear Draw Bolt Locking System
- Coolant Thru
- Dynamically Pre-Balanced G2.5 @ 25,000 RPM or < 1gmm
- Tapers are ground better than AT3 for optimal T.I.R.

Optional (Order Separately):

- Wrench
- Torque Wrench
- Collets, STD and Jet-Blast
- DIN-B Flange Coolant
- Fine Trim Balance
(Sample cutter required for balance compensation)

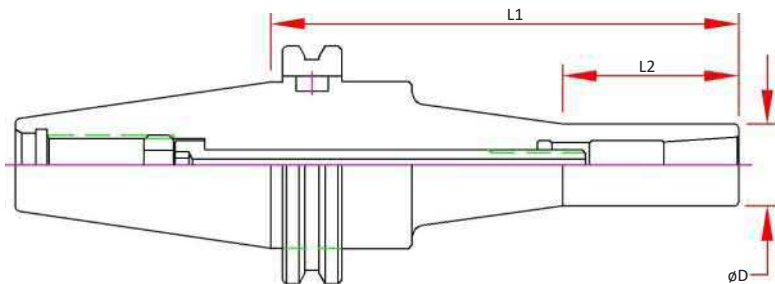

| Dual Contact Spindle Part Number | Standard Spindle Part Number | Collet Range | D | L1 Projection | L2 | Collet | Wrench | Locking Torque Max. |
|----------------------------------|------------------------------|---------------|-------|---------------|------|--------|--------|---------------------|
| CAT40-MX06-085-B | CAT40-MX06-085 | 0.079 - 0.250 | 0.50 | 3.35 | 1.42 | MX06 | | |
| CAT40-MX06-150-B | CAT40-MX06-150 | | | 5.91 | | | | |
| CAT40-MX08-085-B | CAT40-MX08-085 | 0.125 - 0.394 | 0.787 | 3.35 | 1.42 | MX08 | MXW05 | 20 ft/lbs |
| CAT40-MX08-120-B | CAT40-MX08-120 | | | 4.72 | | | | |
| CAT40-MX08-150-B | CAT40-MX08-150 | | | 5.91 | | | | |
| CAT40-MX12-090-B | CAT40-MX12-090 | 0.157 - 0.500 | 1.00 | 3.54 | 1.38 | MX12 | | |
| CAT40-MX12-120-B | CAT40-MX12-120 | | | 4.72 | | | | |